

# Guildhall Arts Centre

St. Peter's Hill,  
Grantham  
Lincolnshire NG31 6PZ

**Box Office:** 01476 406158  
**Email:** [boxoffice@southkesteven.gov.uk](mailto:boxoffice@southkesteven.gov.uk)  
**Web:** [www.guildhallartscentre.com](http://www.guildhallartscentre.com)

## Technical specifications

Dear

Please find enclosed our technical information and stage plan. If any pre-arrival rigging can be done by me to save time on the day, please return my rig plan with your lighting rig on it. Hopefully this will aid us both and should save a lot of unnecessary phone calls.

Please also return the information sheet.

Hope to hear from you soon with times for your arrival and any other queries you may have.

Until then....

David Pike

Senior Theatre Technician

**Guildhall Arts Centre  
Theatre Technical Specifications**

Please fill in any information that will be of use to us prior to your arrival. Thank you.

Venue:

Date:

Show:

Time access required:

Pre arrival LX rig required:

Number of extra bodies

Get In:

Fit Up:

Show:

Get Out:

Number of cast:

Time of show:

Length 1st half:

Length of interval:

Length 2nd half:

Length of get out:

Type of set:

Sound check:

Fire / smoke / Pyro check:

Contact numbers:

Please also inform us if you are planning on using follow spots and if you require us to supply the operators. \*1

Extra sound equipment to be operated from the Right balcony.

Any other information; \*1

\*1 This affects your seating plan



**Guildhall Arts Centre  
Theatre Technical Specifications**

**General**

Rigging in the theatre and ballroom is all done off ladders.

All electrical equipment must be HSW Act 1974, the PUWER 1998 and the EAW Regulations 1989 compliant.

Allow time for the programming of the lighting board.

We only have a limited stock of gel.

The theatre is generally operated by one technician, if additional staffing is required please let us know in advance.

We do not carry music stands or stand lights, we can rig 2 minuette zooms from LX2 but this will reduce the lamp stock.

**Please Note:**

**It is essential that you DO NOT:**

Nail or screw into the stage floor or walls.

Pin, Staple or Stitch any of the curtains.

Paint the stage or walls.

Attempt to move grid or LX bars.

Fly from the grid without prior consultation with technical staff.

Smoke on the premises as the venue is a non-smoking venue.

Consume alcohol as the venue operates a non alcohol policy.

**Advance notice**

Advance notice or permission is required for the following to be used:

Cigarettes or any form of smoking – we operate a policy based on the Smoke free Regulations (2007)

Smoke, Haze, Cool Smoke or Dry Ice Machines.

Naked flame or lanterns using naked flame.

Firearms – even if non-operating replicas.

Strobes.

Lasers.

Flammable materials such as straw.

Please notify us if you intend to use radio mics and send details of frequencies.

# Lighting

---

## *Permanently rigged*

8 x 1KW CCT Silhouette (15°32) (rigged FOH Bar1)  
6 x 1 KW CCT Starlette Fresnel (rigged FOH Bar1)  
8 x 1KW CCT Floods (6 DS OH RGB, 2 FOH Bar2)  
1 x 12in Mirror ball with 2 x RGBW LED spots (DMX)(FOH Bar2)  
4 x ArcBars 3 showtec LED's RGB (DS OH)  
2x 4ft UV's (DS OH)  
2 x LEDJ pars RGBAW (DS OH outer)  
2 x LEDJ Pars RGB (CS OH outer)  
2 x 1Kw 6 way battern floods(L101, L106, L021, L124, L132, L119)  
2 x Stairville Stage Flood QCL RGBW (US OH)

## *NonPermanently rigged*

2 x 1KW CCT Silhouette (15°32)  
10 x 1 KW CCT Starlette Fresnel  
12 x 650W CCT Minuette Fresnel (these are often used elsewhere – please check)  
6 x 650W CCT Minuette Profile  
1 x 1KW CCT Floods (these are often used elsewhere – please check)  
14 x 1KW Thomas Parcan (these are often used elsewhere – please check)  
2 x 2.5KW CCT Follow-spot (operators to be found by company – ask if this is a problem Please note this affects you seating plan)

## *Control*

1 x ETC Element  
9 x Zero88 Beta pack 3 rack. 6 channels per rack. Max handling 2K 10 amp per channel.  
1 x 6 channel 5-amp switching pack for special effects.

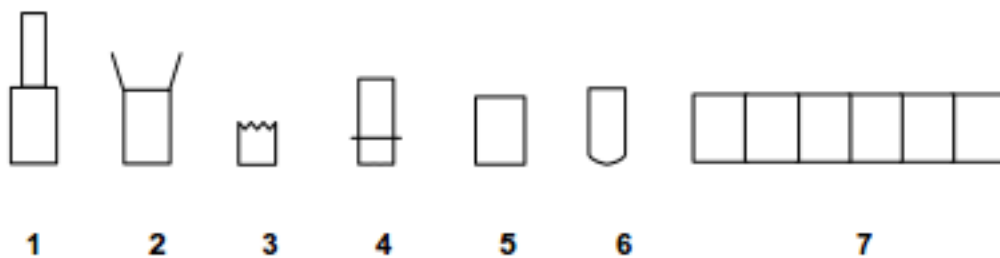

1 = 1KW CCT Silhouette (15°32)  
2 = 1 KW CCT Starlette Fresnel  
3 = 650W CCT Minuette Fresnel  
4 = 650W CCT Minuette Profile  
5 = 1KW CCT Floods  
6 = 1KW Thomas Parcan  
7 = Battern floods

**Guildhall Arts Centre  
Theatre Technical Specifications**

*LX BARS:*

- FOH Bar 1 @ 14 Circuits
- FOH Bar 2 @ 14 Circuits (NB this bar is useless)
- FOH Verticals @ 6 Circuits
- Stage Bar 3 @ 14 Circuits
- Stage Bar 4 @ 14 Circuits
- Stage Bar 5 @ 20 Circuits

*DIPS:*

- 4 Circuits @ DSL
- 4 Circuits @ DSR
- 2 Circuits @ USL
- 2 Circuits @ USR

## Video

---

- 1 x blu ray Player
- 1 x Mac mini (QLAB) (shared with Sound)
- 1 x Optima TX665UST-3D ultra short throw (US onto cyc)
- 1 x Sanyo PLC-X57 (FOH LX bar 1 onto DS screen)
- 1 x Projection screen 3.6m x 3.6m (DS)

## Sound

---

**FOH PA**

*Control*

- 1 x Allen & Heath GLD 80
- 1 x AR2412

*EV array*

- 4 x EVF-1152D/64
- 2 x EFH-1152D/15

*Monitor/infill's*

- 4 x EV ZX1 monitor
- 4 x Peavey wedge monitors
- 2 x Peavey wedge powered monitors
- 4x move 100 power monitor
- 2 x Hz Stage fills (permanently Rigged)

*Playback*

- 1 x Sony MD player
- 1 x Numark CD Player
- 1 x Mac Mini (QLAB) (shared with video)

**Guildhall Arts Centre  
Theatre Technical Specifications**

**Tie lines**

From the stage to the control room

*Stage Left*

- 8 x Send
- 2 x Return

*Stage Right*

- 8 x Send
- 2 x Return

*Pit*

- 8 x Send
- 2 x Return

**MICROPHONES**

- 8 x Sennheiser ew300 G3 radio Mic (body Pack)
- 6 x A.K.G 321
- 2 x A.K.G C568EB Rifle Mic
- 3 x A.K.G C547BL Condenser Plate Mic
- 5 x SM57
- 1 x A.K.G P2 Kick Mic
- 1 x Takstar 7 piece Drum set

## Stage FX

---

- 1 x Le Maitre Postages two way detonator and 2 single flash pods.
- 2 x Antari Lowfogger
- 1 x stage hazer

# Guildhall Arts Centre Theatre Technical Specifications

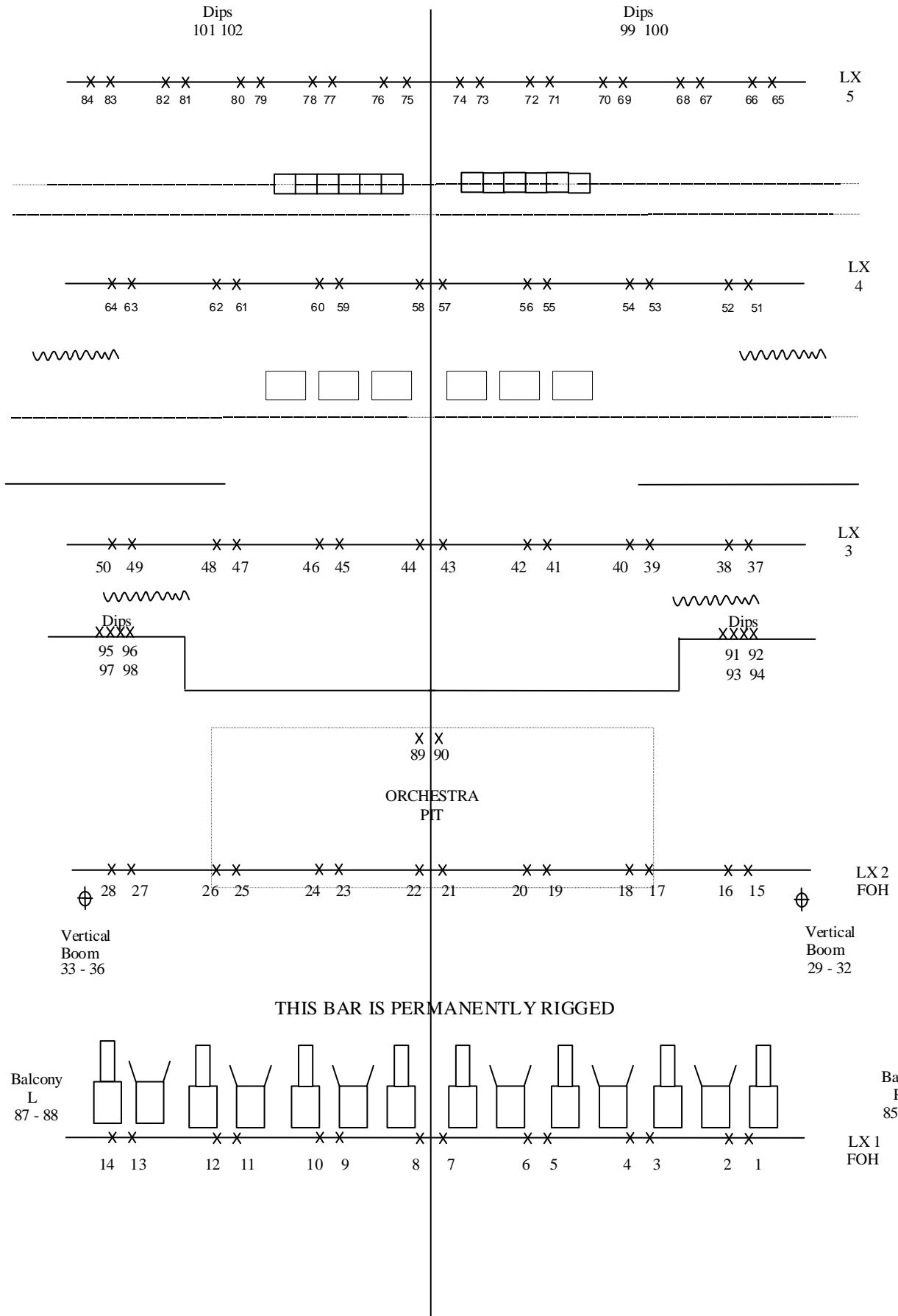



# Guildhall Arts Centre Theatre Technical Specifications

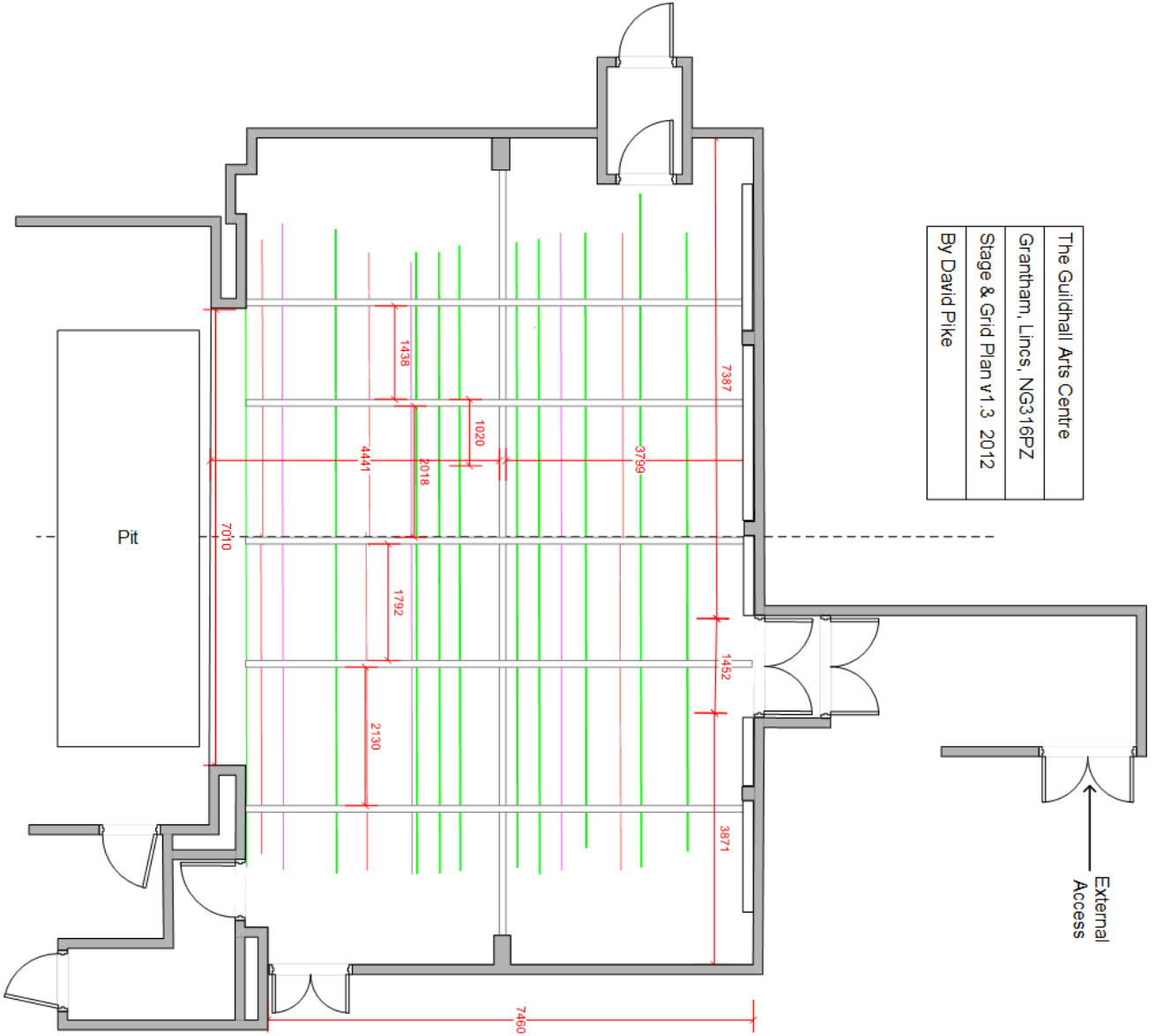

The Guildhall Arts Centre  
 Grantham, Lincs, NG3 16PZ  
 Stage & Grid Plan v1.3 2012  
 By David Pike

**Not To Scale**  
 All measurements are in mm unless stated  
 Floor to bottom of RSJ = 5944mm

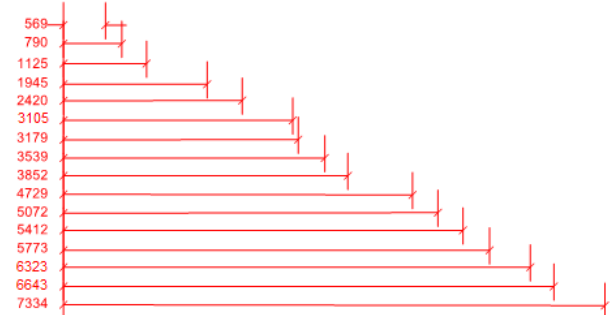
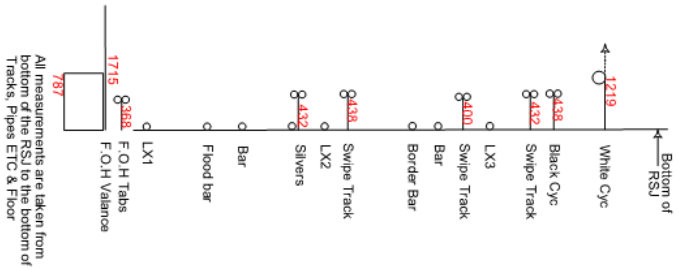

All measurements are taken from bottom of the RSJ to the bottom of Tracks, Pipes ETC & Floor